

WETLAND MIXES

PROVIDE QUANTITY SPECIFIED TO BE FIELD SITED BY LANDSCAPE ARCHITECT

CALLOUT	COMMON NAME	BOTANICAL NAME	REMARKS	
WETLAND MIX 1	BUSHY BLUESTEM FLATSEDGE INLAND SEA OATS OBEDIENT PLANT PALMETTO SOFT RUSH SPIKERUSH (SHORT) WATER CLOVER WATER DAISY AMERICAN WATER-WILLOW ARROWHEAD HARD-STEM BULRUSH IRIS PICKERELWEED OBEDIENT PLANT SPIKERUSH (TALL) THREE-SQUARE BULRUSH	ANDROPOGON GLOMERATUS CYPERUS ODOATUS CHASMANTHIUM LATIFOLIUM PHYSOTEGIA ANGUSTIFOLIA SABAL MINOR JUNCUS EFFUSUS ELEOCHARIS MACROSTACHYA MARSILEA MACROPODA SPILANTHES AMERICANA JUSTICIA AMERICANA SAGITTARIA PLATYPHYLLA SCHOENOPLECTUS ACUTUS IRIS FULVA PONTEDERIA CORDATA PHYSOTEGIA ANGUSTIFOLIA ELEOCHARIS ROSTELLATA SCHOENOPLECTUS AMERICANUS	POND EDGE ZONE - UP TO 6" DEPTH	854 SF
WETLAND MIX 2	AMERICAN WATERWEED EELGRASS PONDWEED WATER STAR GRASS	ELODEA CANADENSIS VALLISNERIA AMERICANA POTAMOGETON PECTINATUS HETERANTHERA DUBIA	MARSH ZONE - 6" TO 2' DEPTH	892 SF
WETLAND MIX 3	AMERICAN WATERWEED EELGRASS PONDWEED WATER STAR GRASS	ELODEA CANADENSIS VALLISNERIA AMERICANA POTAMOGETON PECTINATUS HETERANTHERA DUBIA	DEEP WATER ZONE - 2' TO 4' DEPTH	379 SF

PROVIDE QUANTITY OF PLANTS FOR SPACING SPECIFIED. MIX TOGETHER WITH PLANTS OF SAME SPECIES TYPICALLY IN CLUSTERS OF 2-8 PLANTS. FIELD LOCATION TO BE VERIFIED BY LANDSCAPE ARCHITECT.

PLANTERS

CALLOUT	COMMON NAME	BOTANICAL NAME	SIZE	CONT/ B&B	SPACING	REMARKS	QTY.
PLANTER A	SPINELESS PRICKLY PEAR BULBINE	OPUNTIA SP. 'SPINELESS' BULBINE FRUTESCENS	5 GAL. 1 GAL.	CONT CONT	3 PER PLANTER 8 PER PLANTER		5
PLANTER B	TOOTHLESS SOTOL MEXICAN FEATHER GRASS PINK SKULLCAP	DASYLIRON LONGISSIMUM STIPA TENUISSIMA SCUTELLARIA SUFRUTESCENS	10 GAL. 1 GAL. 1 GAL.	CONT CONT CONT	1 PER PLANTER 3 PER PLANTER 5 PER PLANTER		6
PLANTER C	HARVARD AGAVE SILVER PONYFOOT	AGAVE HARVARDIANA DICHONDRA ARGENTEA	10 GAL. 1 GAL.	CONT CONT	1 PER PLANTER 7 PER PLANTER		2
PLANTER D	AGAVE SILVER PONYFOOT	AGAVE AMERICANA DICHONDRA ARGENTEA	10 GAL. 1 GAL.	CONT CONT	1 PER PLANTER 7 PER PLANTER		4

NOTE:
SET TOP OF ROOTBALL 3" ABOVE
FINISH GRADE. BUILD 4" HT. SAUCER
AROUND PLANTING PIT WITH TOPSOIL.

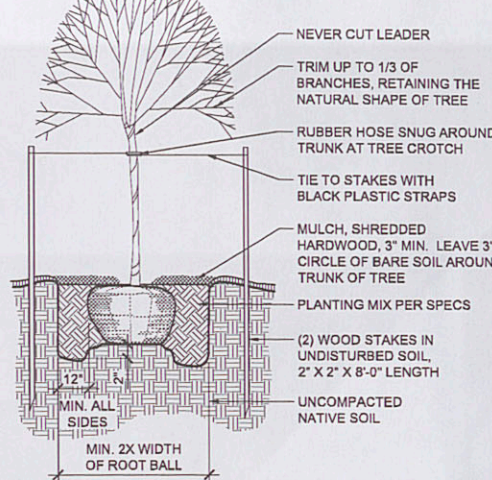

1 TREE PLANTING

NOTE:
SET TOP OF ROOTBALL 3" ABOVE FINISH GRADE. BUILD
4" HT. SAUCER AROUND PLANTING PIT WITH TOPSOIL.

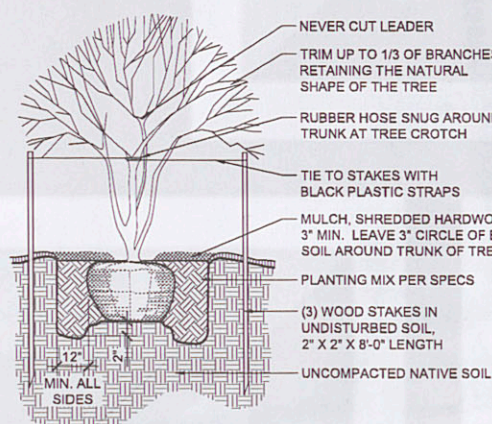

2 ORNAMENTAL TREE PLANTING

DETAIL N.T.S.

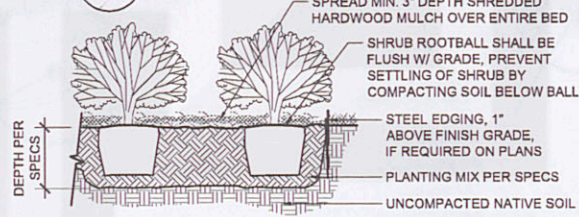

3 SHRUB BED PLANTING

DETAIL N.T.S.

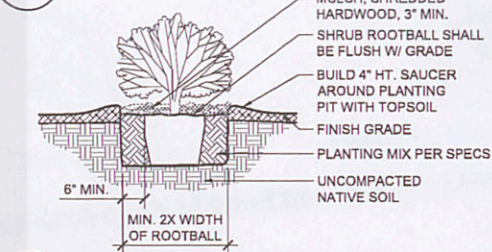

4 SHRUB PIT PLANTING

DETAIL N.T.S.

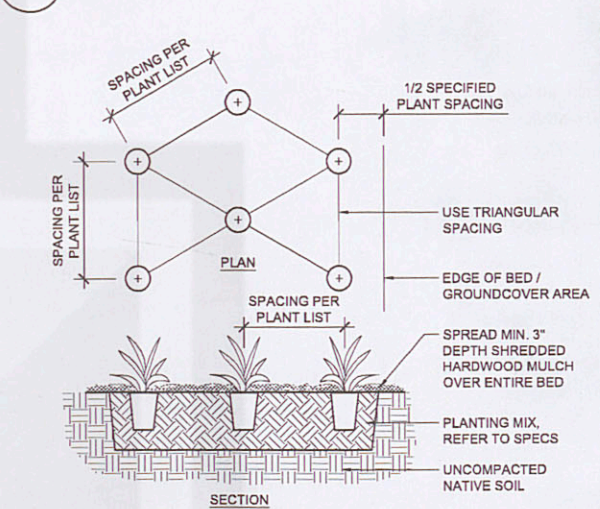

5 GROUND COVER PLANTING

DETAIL N.T.S.

PLANTING NOTES

- COMPLETE ALL LANDSCAPE PLANTING AND RELATED EARTHWORK INCLUDING ALL PRODUCTS, EQUIPMENT AND LABOR. FOR THE LANDSCAPE AREAS SHOWN ON THE DRAWING AND DESCRIBED IN THE SPECIFICATIONS.
- ALL QUESTIONS SHOULD BE REFERRED TO THE PROJECT LANDSCAPE ARCHITECT.
- INFORMATION PROVIDED ON THIS PLAN IS GENERAL IN NATURE. DIMENSIONS, LOCATIONS, AND AREAS ARE APPROXIMATE AND SHOULD BE FIELD VERIFIED PRIOR TO BIDDING & INSTALLATION.
- QUANTITIES SHOWN FOR PLANT MATERIALS ARE APPROXIMATE AND CONTRACTOR IS TO VERIFY. ACTUAL INSTALLED QUANTITIES OF PLANT MATERIALS MAY VARY FROM THE PLAN AND SHOULD BE FIELD DETERMINED ACCORDING TO THE GIVEN SPACING AND FIELD CONDITIONS. DISCREPANCIES BETWEEN FIELD CONDITIONS AND THE PLAN WHICH LIMIT THE CONTRACTOR SHOULD BE BROUGHT TO THE ATTENTION OF THE LANDSCAPE ARCHITECT PRIOR TO INSTALLATION.
- BY BIDDING, THE CONTRACTOR ACKNOWLEDGES THAT HE/SHE HAS SATISFIED HIMSELF/HERSELF AS TO THE NATURE AND LOCATION OF THE WORK AND TO THE QUALITY OF SURFACE AND SUBSURFACE MATERIALS OR OBSTACLES INsofar AS THIS DATA IS REASONABLY ASCERTAINABLE FROM AN INSPECTION OF THE SITE. ANY FAILURE BY THE CONTRACTOR TO ACQUAINT HIMSELF/HERSELF WITH THE AVAILABLE INFORMATION WILL NOT RELIEVE HIM/HER FROM RESPONSIBILITY FOR ESTIMATING PROPERLY THE DIFFICULTY OR COST OF SUCCESSFULLY PERFORMING THE WORK AS DESCRIBED.
- INSTALLATION OF ALL LANDSCAPING MUST BE COORDINATED WITH THE INSTALLATION OF RELATED IRRIGATION, SITE WORK, SITE LIGHTING, SITE SIGNAGE AND GRADING.
- UNLESS SPECIFICALLY NOTED, INSTALL ALL MASSED PLANTING UTILIZING EQUILATERAL TRIANGULAR SPACING. EDGE PLANTING BEDS INDICATED WITH STEEL EDGING BETWEEN MULCHED AREAS AND GRASS. EDGING NEED NOT BE INSTALLED BETWEEN CURBS OR WALLS AND LANDSCAPED AREAS.
- FORM 3" DEEP EARTHEN SAUCERS AROUND ALL TREES. DO NOT INSTALL OTHER VEGETATION WITHIN THE SAUCER OF ANOTHER PLANT.
- EVENLY APPLY 3" OF MULCH TO ALL CONTINUOUS PLANTING BEDS. TREES OCCURRING IN TURF AREAS SHOULD BE MULCHED WITHIN THE SOIL SAUCERS.
- PLANT MATERIAL AND LAYOUT MUST BE APPROVED BY THE LANDSCAPE ARCHITECT PRIOR TO INSTALLATION.
- ALL IDENTIFICATION TAGS PROVIDED BY GROWERS AND PLACED ON TREES AND SHRUBS ARE TO REMAIN ON THE PLANTS THROUGH THE PUNCH-LIST INSPECTION. TAGS ARE TO BE REMOVED PRIOR TO FINAL ACCEPTANCE, OR UPON REQUEST OF THE LANDSCAPE ARCHITECT.
- ALL SODDING AND SEEDING OF LAWN AREAS IS TO BE COMPLETED AS A PART OF THE LANDSCAPE CONTRACT. A MINIMUM OF 4" OF QUALITY BROWN OR BLACK TOPSOIL IS TO BE PROVIDED FOR ALL SOD AND SEED AREAS.
- TOPSOIL AND SEEDING ARE TO BE APPLIED TO ALL CONSTRUCTION-DAMAGED GROUND SURFACES NOT OTHERWISE PLANTED OR SODDED. CONTRACTOR SHALL REVIEW RELATED CONSTRUCTION DRAWINGS FOR LIMITS OF CONSTRUCTION AND SHALL ALSO BE RESPONSIBLE FOR COORDINATING WITH OTHER SITE CONTRACTORS TO DETERMINE ACTUAL AREAS OF SEEDING REQUIRED, INCLUDING AREAS DISTURBED BY UTILITY EXTENSIONS.
- PLANTERS MIX IS TO BE USED FOR PLANTING BEDS, REFERENCE SPECIFICATIONS.
- ALL LANDSCAPED AREAS ARE TO IRRIGATED WITH AN UNDERGROUND AUTOMATIC IRRIGATION SYSTEM. IRRIGATION CONTRACTOR IS TO BE A STATE OF TEXAS LICENSED IRRIGATOR, AND IS TO FOLLOW TCEQ.
- PROVIDE REGULAR MAINTENANCE OF ALL LANDSCAPE AREAS AND PLANT MATERIALS IN A VIGOROUS AND HEALTHY CONDITION, FREE FROM DISEASES, PEST WEEDS, AND LITTER. THIS MAINTENANCE SHALL INCLUDE WEEDING, WATERING, FERTILIZATION, PRUNING, MOWING, EDGING, MULCHING OR OTHER NEEDED MAINTENANCE, IN ACCORDING WITH GENERALLY ACCEPTED HORTICULTURAL PRACTICES UNTIL THE PROJECT HAS BEEN ACCEPTED BY THE OWNER AND LANDSCAPE ARCHITECT.
- REPAIR OR REPLACE REQUIRED LANDSCAPE STRUCTURES (WALLS, FENCES, ETC.) IF DAMAGED. CONTRACTOR TO INSURE THAT ALL WORK IS STRUCTURALLY SOUND AND REPLACED TO ORIGINAL CONDITION.

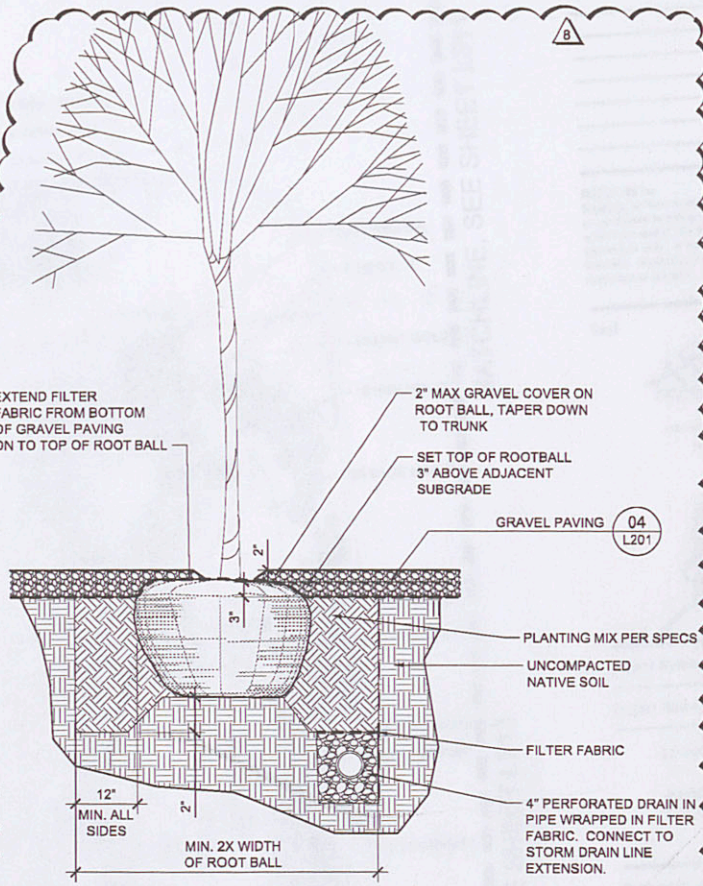

06 TREE PLANTING IN GRAVEL

SECTION N.T.S.

Architecture Planning Interiors Research
175 Toyota Plaza, Suite 600
Memphis, Tennessee 38103
Telephone 901 521 1440
Fax 901 525 2760
E-mail info@lrk.com

Client:

LOADSTAR, Inc.

9830 Colonnade Boulevard, Suite 600

San Antonio, Texas 78230

Issues and Revisions

Date	Issues
01/27/12	Design Development
03/23/12	CD Check Set
06/08/12	La Cantera Pricing Set
07/11/12	Permit Set
10/11/12	For Construction

No.	Date	Revisions
8	10/15/12	For Construction Set

©2010 LRK Inc.
Drawings, written material, and design concepts shall not be used or reproduced in whole or part in any form or format without prior written consent of LRK Inc. Do not scale drawings. Use given dimensions only. If not shown, verify correct dimensions with the Architect. Contractor shall check and verify all dimensions and conditions at job site.

Seal
J. Anderson
LANDSCAPE ARCHITECTS
3708 MANCILLA ROAD - AUSTIN, TEXAS 78704
(512) 499-7124
WWW.JRANDERSON.COM



Project Number: 01.11073.00

Project Name:

La Cantera Phase I

Market Street

San Antonio, Texas

Drawing Name:

PLANTING LEGEND, DETAILS AND NOTES

Drawn By: RHD

Checked By: JRA