

L1.104
L1.103

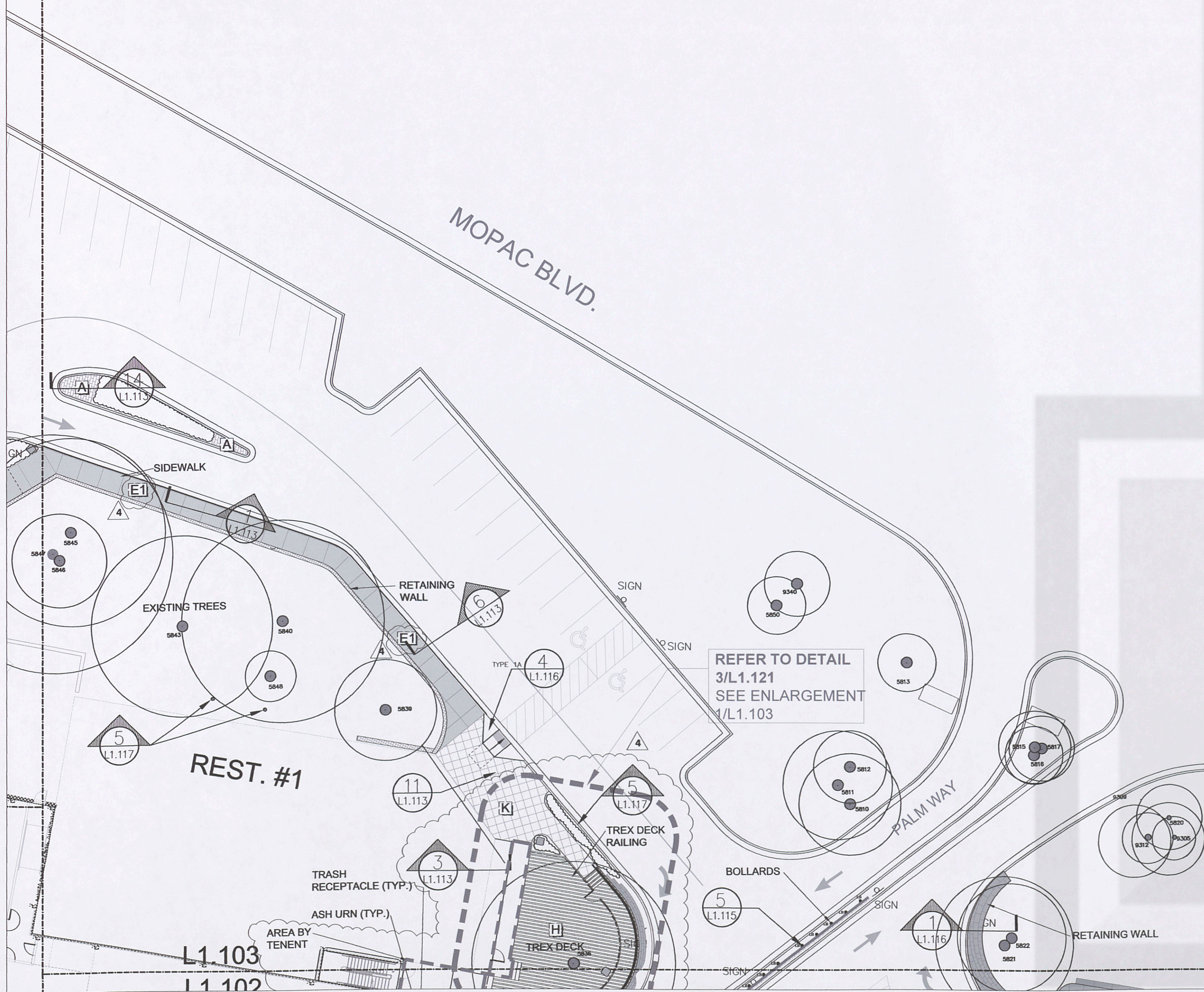

REVISIONS		
DELTA	DATE	DESCRIPTION
1	03/24/06	REVISE HARDSCAPE ELEMENTS DUE TO VARIOUS CHANGES (OWNER-REQUESTED, CIVIL, ARCHITECTURAL)
2	05/10/06	GRANITE GRAVEL PATHS REMOVED FROM WEST PARKING AREA
3	08/08/06	UPDATE TO SITE FURNITURE KEY AND COUNTS
4	09/18/06	REVISE REST. #1/BLDG A DECK AREA

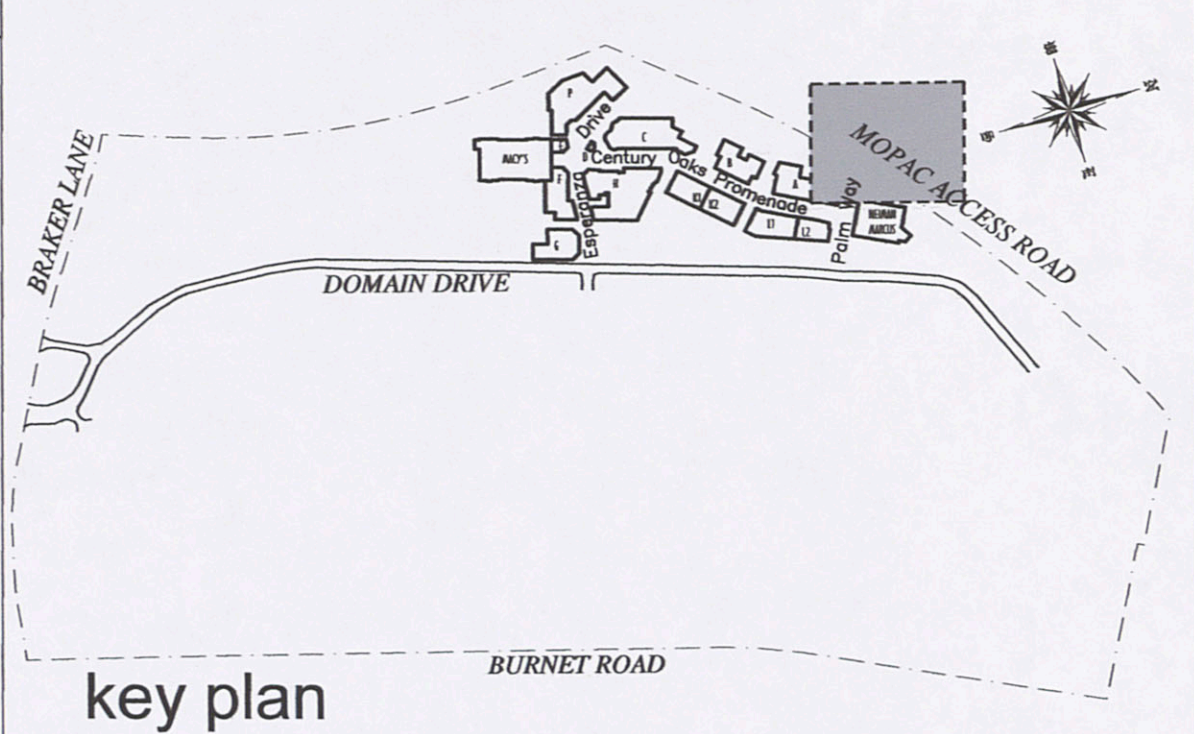

SITE FURNITURE KEY		TOTAL QUANTITY
B1	Backed Aluminum Bench - Ref. Detail 1 Sheet L1.115	22
B2	Backless Aluminum Bench - Ref. Detail 1 Sheet L1.115	18
B3	Backless Wooden Bench - Ref. Detail 1 Sheet L1.115	36
B4	Backless Wooden Bench - Ref. Detail 1 Sheet L1.115	25
	Trash Receptacle - Ref. Detail 7 Sheet L1.115	79
	Ash Urn - Ref. Detail 3 Sheet L1.115	28
	Bike Rack - Ref. Detail 6 Sheet L1.115	10
BE	Bollards - Ref. Detail 14 Sheet L1.114	38
RB	Bollards - Ref. Detail 15 Sheet L1.114	43
LB	Bollards - Ref. Detail 5 Sheet L1.115	14
	Directional Kiosk By Owner	2
	Directional Kiosk By Owner	2
	Directional Kiosk By Owner	1
	Future Art Locations By Owner	5
	Atrium Grates in Landscape Areas (NDS Drains)	85
	Hardscape Drain (Smith Drains)	41

PAVING AND MATERIALS LEGEND	
A	Pine Hall Brick "English Edge" Series - Color: Autumn
B	Pine Hall Brick "English Edge" Series - Color: Buff
C	Lueders Caramel Limestone - Broken Pattern
D	Arizona Sandstone - Random Coursed Ashlar Pattern; Color: Buckskin
D1	Arizona Sandstone - Broken Pattern; Color: Buckskin
E	Standard Grey Concrete - Rock Salt Finish with running bond pattern for streetscape areas.
E1	Standard Grey Concrete - Medium broom finish with 3" smooth trowel banding for back of house sidewalks @ parking garage walks.
F	Accent Banding - Scofield Admixture Color Concrete - Medium Broom Finish; Color: Westwood Brown
G	General Field - Scofield Admixture Color Concrete - Rock Salt Finish; Color: Harvest Wheat
H	Trex Accent Decking - Color: Saddle
I	Asphalt Paving per Civil Engineer specs.
J	Decomposed Crushed Granite Gravel
K	Adobe Tan - Scofield Admixture Color Concrete - square pattern; Medium Broom Finish

A JOINT VENTURE OF:

SIMON | **ENDEAVOR**

REAL ESTATE GROUP

J. Robert Anderson, FASLA

landscape architects - austin, texas -

3718 MANCHACA ROAD
AUSTIN, TEXAS 78704
512.440.1040
440-8000 FAX

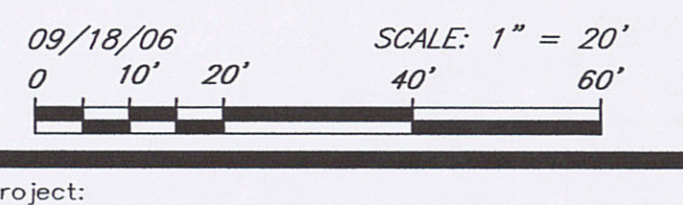
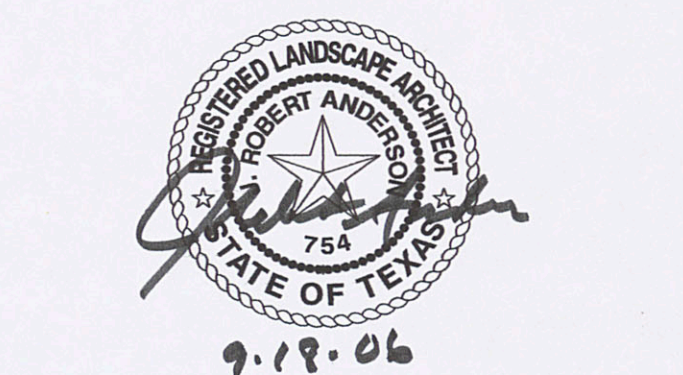

Project:

the domain
AUSTIN, TEXAS

JPRA ARCHITECTS

31000 Northwestern, Suite 105
10000 North Loop West, Suite 105
Houston, Texas 77040
phone 281.737.0180 fax 281.737.9141

SHEET TITLE:
HARDSCAPE MATERIALS PLAN

Sheet No.
L1.103