

BAYLOR UNIVERSITY

PARKING GARAGE, PLAZA & STREETSCAPE

1521 SO. 4th ST.
WACO, TEXAS 76707

Revisions:

No.	Date:	By:	Description:

J. Robert Anderson, FASLA
Landscape Architect



1715 S. Capital of TX Hwy., Ste. 105
Austin, TX 78746

email jra0@airmail.net ph. 512.329.8882
fax 512.329.8883

Key Plan:

Sheet Title:

OVERALL SITE DESIGN

IRRIGATION PLAN

Job Name: BU-pkg	Scale: 1"=20'
Issue Date: 7/22/99	Issue For:
Drawn By: J.C.	Checked By: D.B.

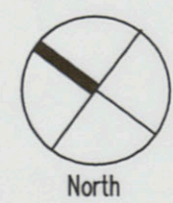

Sheet #:
1
OF
2

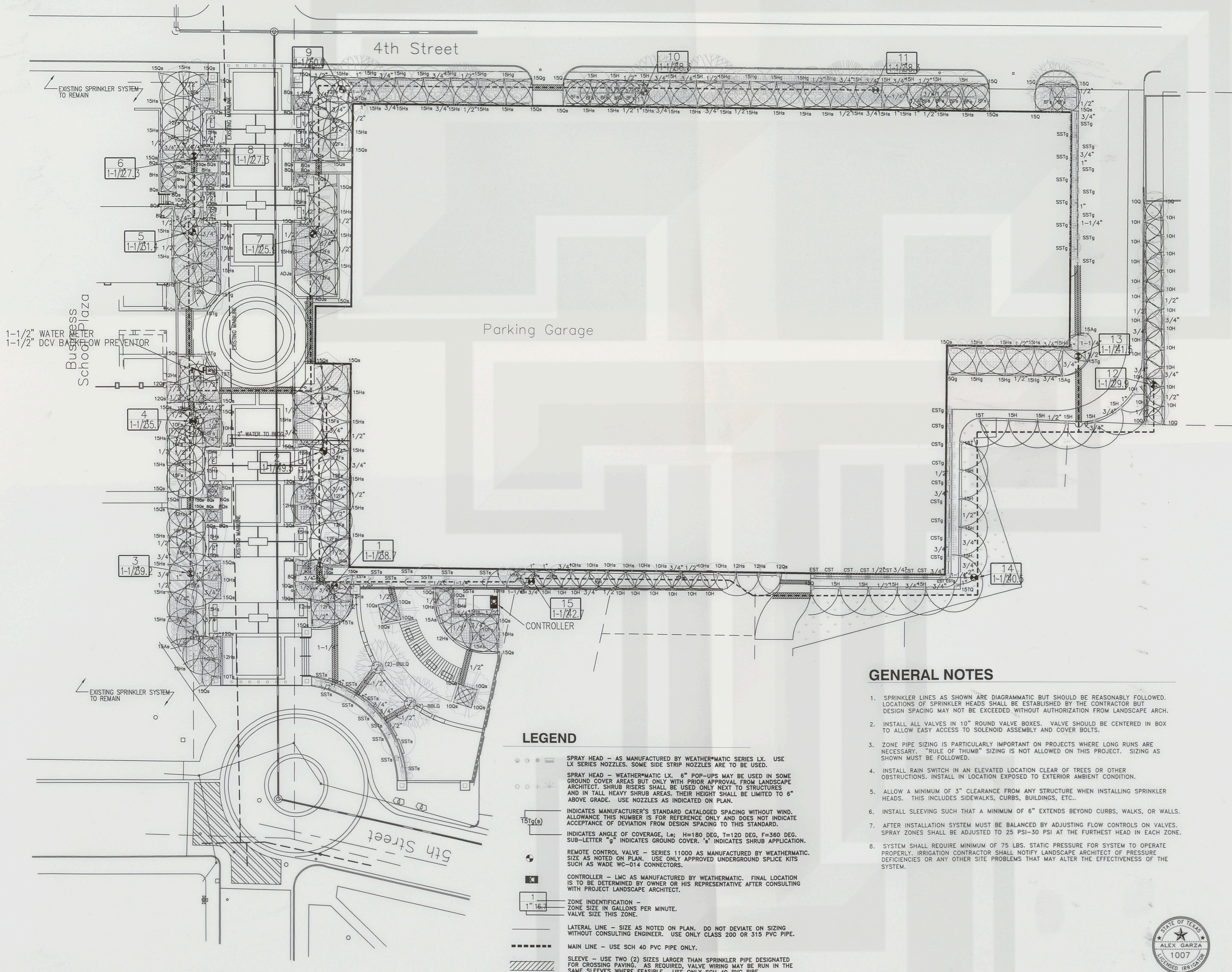

GENERAL NOTES

1. SPRINKLER LINES AS SHOWN ARE DIAGRAMMATIC BUT SHOULD BE REASONABLY FOLLOWED. LOCATIONS OF SPRINKLER HEADS SHALL BE ESTABLISHED BY THE CONTRACTOR BUT DESIGN SPACING MAY NOT BE EXCEEDED WITHOUT AUTHORIZATION FROM LANDSCAPE ARCH.
2. INSTALL ALL VALVES IN 10" ROUND VALVE BOXES. VALVE SHOULD BE CENTERED IN BOX TO ALLOW EASY ACCESS TO SOLENOID ASSEMBLY AND COVER BOLTS.
3. ZONE PIPE SIZING IS PARTICULARLY IMPORTANT ON PROJECTS WHERE LONG RUNS ARE NECESSARY. "RULE OF THUMB" SIZING IS NOT ALLOWED ON THIS PROJECT. SIZING AS SHOWN MUST BE FOLLOWED.
4. INSTALL RAIN SWITCH IN AN ELEVATED LOCATION CLEAR OF TREES OR OTHER OBSTRUCTIONS. INSTALL IN LOCATION EXPOSED TO EXTERIOR AMBIENT CONDITION.
5. ALLOW A MINIMUM OF 3" CLEARANCE FROM ANY STRUCTURE WHEN INSTALLING SPRINKLER HEADS. THIS INCLUDES SIDEWALKS, CURBS, BUILDINGS, ETC..
6. INSTALL SLEEVING SUCH THAT A MINIMUM OF 6" EXTENDS BEYOND CURBS, WALKS, OR WALLS.
7. AFTER INSTALLATION SYSTEM MUST BE BALANCED BY ADJUSTING FLOW CONTROLS ON VALVES. SPRAY ZONES SHALL BE ADJUSTED TO 25 PSI-30 PSI AT THE FURTHEST HEAD IN EACH ZONE.
8. SYSTEM SHALL REQUIRE MINIMUM OF 75 LBS. STATIC PRESSURE FOR SYSTEM TO OPERATE PROPERLY. IRRIGATION CONTRACTOR SHALL NOTIFY LANDSCAPE ARCHITECT OF PRESSURE DEFICIENCIES OR ANY OTHER SITE PROBLEMS THAT MAY ALTER THE EFFECTIVENESS OF THE SYSTEM.

LEGEND

- SPRAY HEAD - AS MANUFACTURED BY WEATHERMATIC SERIES LX. USE LX SERIES NOZZLES. SOME SIDE STRIP NOZZLES ARE TO BE USED.
- SPRAY HEAD - WEATHERMATIC LX. 6" POP-UPS MAY BE USED IN SOME GROUND COVER AREAS BUT ONLY WITH PRIOR APPROVAL FROM LANDSCAPE ARCHITECT. SHRUB RISERS SHALL BE USED ONLY NEXT TO STRUCTURES AND IN TALL HEAVY SHRUB AREAS. THEIR HEIGHT SHALL BE LIMITED TO 6" ABOVE GRADE. USE NOZZLES AS INDICATED ON PLAN.
- INDICATES MANUFACTURER'S STANDARD CATALOGED SPACING WITHOUT WIND. ALLOWANCE THIS NUMBER IS FOR REFERENCE ONLY AND DOES NOT INDICATE ACCEPTANCE OF DEVIATION FROM DESIGN SPACING TO THIS STANDARD.
- INDICATES ANGLE OF COVERAGE, I.e. H=180 DEG, T=120 DEG, F=360 DEG. SUB-LETTER "g" INDICATES GROUND COVER. "s" INDICATES SHRUB APPLICATION.
- REMOTE CONTROL VALVE - SERIES 11000 AS MANUFACTURED BY WEATHERMATIC. SIZE AS NOTED ON PLAN. USE ONLY APPROVED UNDERGROUND SPLICE KITS SUCH AS WADE WC-014 CONNECTORS.
- CONTROLLER - LMC AS MANUFACTURED BY WEATHERMATIC. FINAL LOCATION IS TO BE DETERMINED BY OWNER OR HIS REPRESENTATIVE AFTER CONSULTING WITH PROJECT LANDSCAPE ARCHITECT.
- ZONE IDENTIFICATION - ZONE SIZE IN GALLONS PER MINUTE. VALVE SIZE THIS ZONE.
- LATERAL LINE - SIZE AS NOTED ON PLAN. DO NOT DEVIATE ON SIZING WITHOUT CONSULTING ENGINEER. USE ONLY CLASS 200 OR 315 PVC PIPE.
- MAIN LINE - USE SCH 40 PVC PIPE ONLY.
- SLEEVE - USE TWO (2) SIZES LARGER THAN SPRINKLER PIPE DESIGNATED FOR CROSSING PAVING. AS REQUIRED, VALVE WIRING MAY BE RUN IN THE SAME SLEEVES WHERE FEASIBLE. USE ONLY SCH 40 PVC PIPE.



GARZA CONSULTING
IRRIGATION DESIGN
PLANNING & COST ANALYSIS
1221 TRIPLETT
SAN ANTONIO, TEXAS
PHONE (210) 490-1192