

PLAN NOTES

- CORNER OF BUILDING SHALL BE DEFINED BY CIVIL ENGINEER BY COORDINATE POINTS. POINTS WILL PLACE THE CORNER OF THE STUD WALL AT THE MAIN BODY OF THE BUILDING.
- ALL EXTERIOR DIMENSIONS ARE SHOWN TO FACE OF STUD AT MAIN BODY OF BUILDING, UNLESS NOTED OTHERWISE.
- ALL INTERIOR DIMENSIONS ARE SHOWN TO FACE OF STUD, UNLESS NOTED OTHERWISE.
- ELEVATIONS SHOWN ARE RELATIVE TO MEAN SEA LEVEL, UNLESS NOTED AS A REFERENCE ELEVATION.
- OPDS = OUTSIDE FACE OF STUD
- OPDG = OUTSIDE FACE OF COLUMN
- REFER TO STRUCTURAL SLAB EDGE DRAWING SERIES FOR CLARIFICATION OF SLAB AND GRID DIMENSIONS.
- ALL MECHANICAL, ELECTRICAL, PLUMBING, SECURITY, UTILITY, CABLE TV, AND TELEPHONE EQUIPMENT SHALL BE INSTALLED SO AS NOT TO BE IN CONFLICT WITH ANY WINDOW OR DOOR OPENING.
- ALL GROUND FLOOR DOORS SHALL BE FULLY ACCESSIBLE WITH EXTERIOR PAVEMENT LEVEL WITH INTERIOR SURFACE. PROVIDE POSITIVE DRAINAGE AWAY FROM ALL DOORS.
- PROVIDE 11" TALL CEILING AT UNIT. PROVIDE STEP IN BOTTOM CHORD OF ROOF TRUSS.
- STOOP STAIRS SHALL BE CONSTRUCTED TO MEET GRADE. STAIRS SHALL COMPLY WITH IBC CHAPTER 10. TREADS SHALL BE 11". RISERS SHALL BE A MAXIMUM OF 7" x 11" x 24 TO 26.
- CONCRETE FLOORWORK PER LANDSCAPE DRAWINGS AT FLEX UNIT PATIO.
- REFER TO ELEVATION S/A203d FOR UNIT ENTRY DETAILS FOR THE FOLLOWING UNITS: 390, 391, 392, 393, 394, 395, 396, 397, 398, 399, 400, 401, 402, 403, 404, 405, 406, 407, 408, 409, 410, 411, 412, 413, 414, 415, 416, 417, 418, 419, 420, 421, 422, 423, 424, 425, 426, 427, 428, 429, 430, 431, 432, 433, 434, 435, 436, 437, 438, 439, 440, 441, 442, 443, 444, 445, 446, 447, 448, 449, 450, 451, 452, 453, 454, 455, 456, 457, 458, 459, 460, 461, 462, 463, 464, 465, 466, 467, 468, 469, 470, 471, 472, 473, 474, 475, 476, 477, 478, 479, 480, 481, 482, 483, 484, 485, 486, 487, 488, 489, 490, 491, 492, 493, 494, 495, 496, 497, 498, 499, 500, 501, 502, 503, 504, 505, 506, 507, 508, 509, 510, 511, 512, 513, 514, 515, 516, 517, 518, 519, 520, 521, 522, 523, 524, 525, 526, 527, 528, 529, 530, 531, 532, 533, 534, 535, 536, 537, 538, 539, 540, 541, 542, 543, 544, 545, 546, 547, 548, 549, 550, 551, 552, 553, 554, 555, 556, 557, 558, 559, 560, 561, 562, 563, 564, 565, 566, 567, 568, 569, 570, 571, 572, 573, 574, 575, 576, 577, 578, 579, 580, 581, 582, 583, 584, 585, 586, 587, 588, 589, 590, 591, 592, 593, 594, 595, 596, 597, 598, 599, 600, 601, 602, 603, 604, 605, 606, 607, 608, 609, 610, 611, 612, 613, 614, 615, 616, 617, 618, 619, 620, 621, 622, 623, 624, 625, 626, 627, 628, 629, 630, 631, 632, 633, 634, 635, 636, 637, 638, 639, 640, 641, 642, 643, 644, 645, 646, 647, 648, 649, 650, 651, 652, 653, 654, 655, 656, 657, 658, 659, 660, 661, 662, 663, 664, 665, 666, 667, 668, 669, 670, 671, 672, 673, 674, 675, 676, 677, 678, 679, 680, 681, 682, 683, 684, 685, 686, 687, 688, 689, 690, 691, 692, 693, 694, 695, 696, 697, 698, 699, 700, 701, 702, 703, 704, 705, 706, 707, 708, 709, 710, 711, 712, 713, 714, 715, 716, 717, 718, 719, 720, 721, 722, 723, 724, 725, 726, 727, 728, 729, 730, 731, 732, 733, 734, 735, 736, 737, 738, 739, 740, 741, 742, 743, 744, 745, 746, 747, 748, 749, 750, 751, 752, 753, 754, 755, 756, 757, 758, 759, 760, 761, 762, 763, 764, 765, 766, 767, 768, 769, 770, 771, 772, 773, 774, 775, 776, 777, 778, 779, 780, 781, 782, 783, 784, 785, 786, 787, 788, 789, 790, 791, 792, 793, 794, 795, 796, 797, 798, 799, 800, 801, 802, 803, 804, 805, 806, 807, 808, 809, 810, 811, 812, 813, 814, 815, 816, 817, 818, 819, 820, 821, 822, 823, 824, 825, 826, 827, 828, 829, 830, 831, 832, 833, 834, 835, 836, 837, 838, 839, 840, 841, 842, 843, 844, 845, 846, 847, 848, 849, 850, 851, 852, 853, 854, 855, 856, 857, 858, 859, 860, 861, 862, 863, 864, 865, 866, 867, 868, 869, 870, 871, 872, 873, 874, 875, 876, 877, 878, 879, 880, 881, 882, 883, 884, 885, 886, 887, 888, 889, 890, 891, 892, 893, 894, 895, 896, 897, 898, 899, 900, 901, 902, 903, 904, 905, 906, 907, 908, 909, 910, 911, 912, 913, 914, 915, 916, 917, 918, 919, 920, 921, 922, 923, 924, 925, 926, 927, 928, 929, 930, 931, 932, 933, 934, 935, 936, 937, 938, 939, 940, 941, 942, 943, 944, 945, 946, 947, 948, 949, 950, 951, 952, 953, 954, 955, 956, 957, 958, 959, 960, 961, 962, 963, 964, 965, 966, 967, 968, 969, 970, 971, 972, 973, 974, 975, 976, 977, 978, 979, 980, 981, 982, 983, 984, 985, 986, 987, 988, 989, 990, 991, 992, 993, 994, 995, 996, 997, 998, 999, 1000.

GENERAL NOTES

- REFER TO SHEETS A103 THRU A104 FOR UNIT PLAN ENLARGEMENTS.
- REFER TO SHEET A210 FOR COMMON AREA FINISHES.
- REFER TO FIRST AND SECOND LEVEL PLANS FOR DIMENSIONS AND VERTICAL FIRE LOCATIONS.
- ALIGN ALL OPENINGS WITH OPENINGS BELOW UNLESS NOTED OTHERWISE.
- ALL EXTERIOR WALLS ARE TYPE I/A203d UNLESS NOTED OTHERWISE.

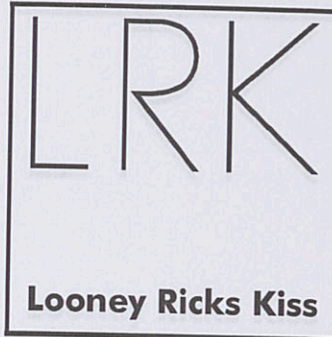
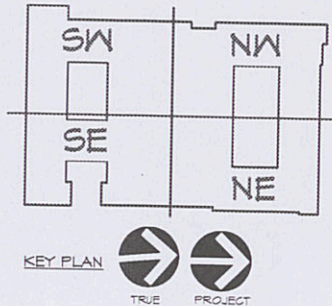

Architecture Planning Interiors Research
175 Toyota Plaza, Suite 600
Memphis, Tennessee 38103
Telephone 901.521.1440
Fax 901.525.2760
E-mail info@lrk.com

Client:

LOADSTAR, Inc.

9830 Colonnade Boulevard, Suite 600

San Antonio, Texas 78230

Issues

Date	Issues
01.27.12	Design Development
04.03.12	50% CD
06.08.12	PRICING SET
07.11.12	PERMIT SET

No.

Date	Revisions
9/12/12	PERMIT SET REVISION
10/15/12	For Construction Set

©2012 LRK Inc.
Drawings, written material, and design concepts shall not be used or reproduced in whole or part in any form or format without prior written consent of LRK Inc. Do not scale drawings. Use given dimensions only. If not shown, verify correct dimensions with the Architect. Contractor shall check and verify all dimensions and conditions at job site.

Seal



Project Number: 01.1073.00

Project Name:

La Cantera Mixed Use

6215 Via La Cantera

San Antonio, Texas 78256

Drawing Name:

Southwest Quadrant

Drawn By: BD, MF, DS

Checked By: BD, BE

A103d

1 Level 3 Southwest Quadrant

1/8" = 1'-0"