

1. UNLESS SPECIFICALLY NOTED, INSTALL ALL MASS PLANTING UTILIZING EQUILATERAL TRIANGULAR SPACING.
2. EVENLY APPLY 3" OF MULCH TO ALL CONTINUOUS PLANTING BEDS. TREES OCCURRING IN TURF AREAS SHOULD BE MULCHED WITHIN THE SOIL SAUCERS.
3. FORM 3" DEEP EARTHEN SAUCERS AROUND ALL TREES. DO NOT INSTALL OTHER VEGETATION WITHIN THE SAUCER OF ANOTHER.
4. SUBSTITUTIONS OF PLANT SPECIES, SIZES, OR OTHER SPECIFIED MATERIALS WILL NOT BE ALLOWED WITHOUT PRIOR APPROVAL BY THE LANDSCAPE ARCHITECT.
5. PLANT MATERIAL AND LAYOUT MUST BE APPROVED BY LLA PRIOR TO INSTALLATION.
6. ALL IDENTIFICATION TAGS PROVIDED BY GROWERS AND PLACED ON TREES AND SHRUBS ARE TO REMAIN ON THE PLANTS THROUGH THE PUNCH-LIST INSPECTION. TAGS ARE TO BE REMOVED PRIOR TO FINAL ACCEPTANCE, OR UPON REQUEST OF LLA.
7. ALL SEEDING OF LAWN AREAS IS TO BE COMPLETED AS A PART OF THE LANDSCAPE CONTRACT. A MINIMUM OF 4" OF APPROVED TOPSOIL IS TO BE PROVIDED FOR ALL SOD AND SEED AREAS.
8. TOPSOIL AND SEEDING ARE TO BE APPLIED TO ALL LANDSCAPE WORK-DAMAGED GROUND SURFACES NOT OTHERWISE PLANTED OR SODDED.
SUBCONTRACTOR SHALL REVIEW RELATED CONSTRUCTION DRAWINGS FOR LIMITS OF CONSTRUCTION AND SHALL ALSO BE RESPONSIBLE FOR COORDINATING WITH OTHER SITE CONTRACTORS TO DETERMINE ACTUAL AREAS OF SEEDING REQUIRED, INCLUDING AREAS DISTURBED BY UTILITY EXTENSIONS.
9. SEE SPECIFICATIONS FOR APPROVED SOIL MIXTURES
10. RE-TRANSPLANT OAKS AND ELMS ARE TO BE APPROVED PRIOR TO TRANSPLANTING. ANY REQUIRED STAKING FOR THESE TREES IS TO BE COORDINATED WITH LANDSCAPE ARCHITECT.
11. DETAIL 5/ L3.0 DOES NOT APPLY TO 18" LIVE OAK. THIS TREE, DUE TO ITS LOCATION WILL HAVE BASALT GRAVEL UP TO TRUNK.

SQUARE FOOTAGE OF PLANTING BEDS

1. PERENNIALS: 15,732 SQAURE FEET
2. GROUNDCOVERS: 7,620 SQAURE FEET
3. ANNUALS: 738 SQUARE FEET

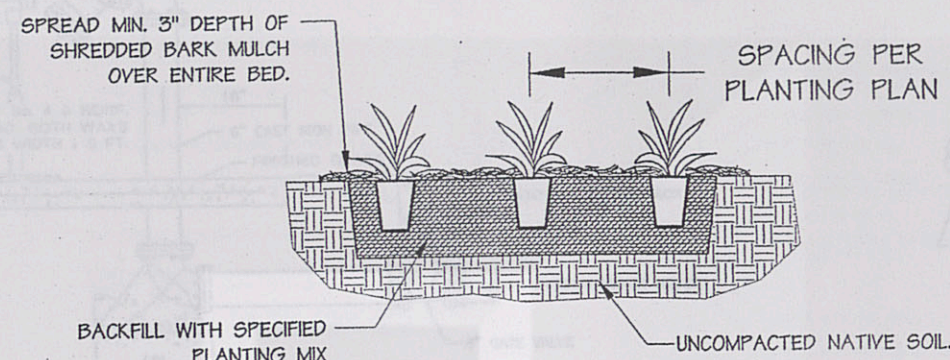

1 NATIVE GRASS/SMALL SHRUB/PLUG PLANTING DETAIL
000 NOT TO SCALE

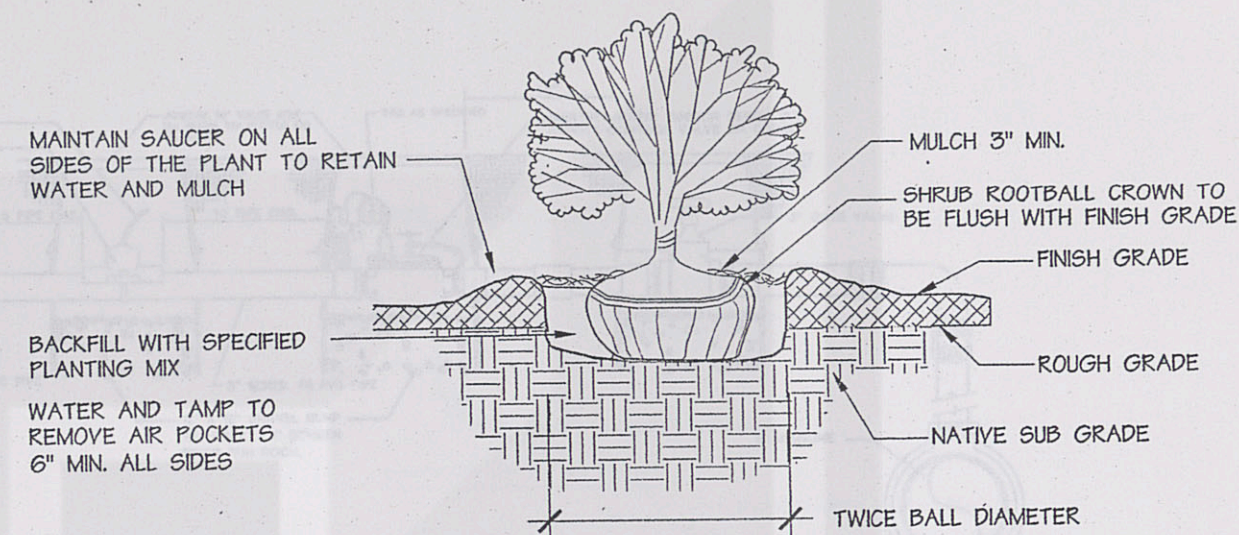

2 SHRUB PIT PLANTING DETAIL
000 NOT TO SCALE

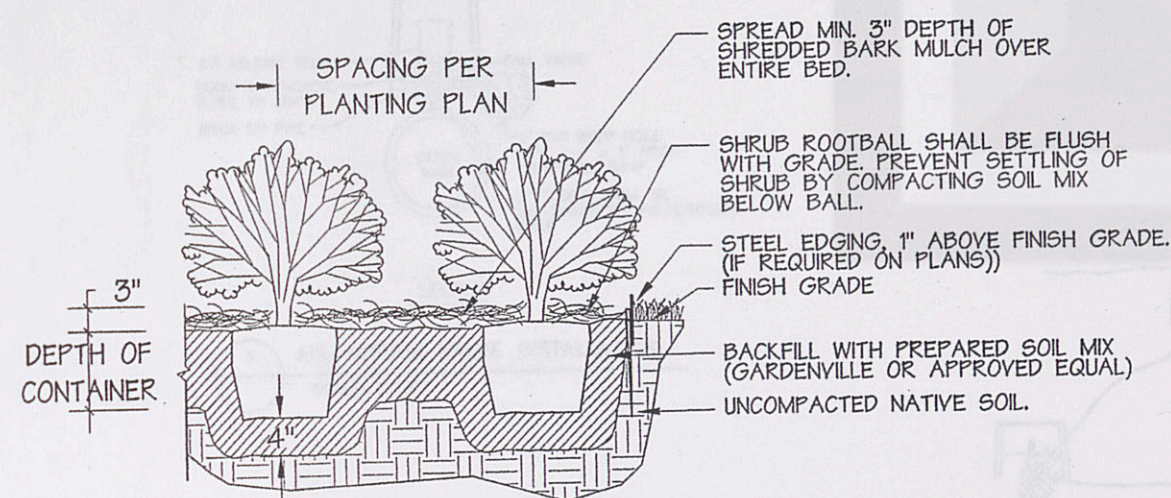

3 SHRUB BED PLANTING DETAIL
000 NOT TO SCALE

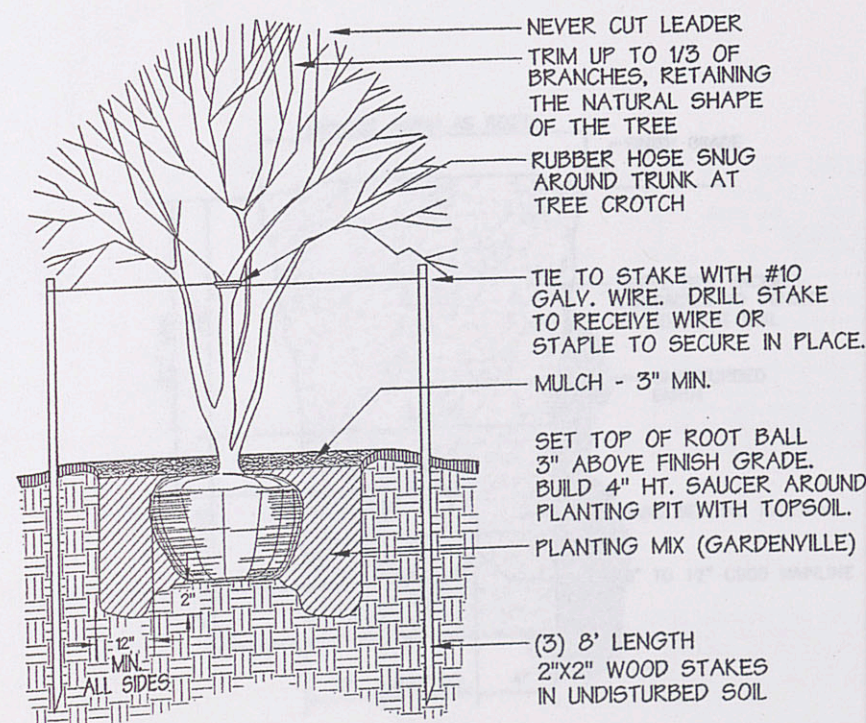

4
000

ORNAMENTAL TREE STAKING DETAIL
NOT TO SCALE

- 3 MODEL 40 DUCKBILL ANCHORS (HOLDING CAPACITY 300# PER ANCHOR IN NORMAL SOIL.
- 12' OF 1/16" 7X7 GALVANIZED STEEL CABLE ATTACHED TO EACH ANCHOR (CAN BE VINYL COATED IN WHITE OR ORANGE FOR HIGH VISIBILITY)
- 3 1/16" CABLE CLAMPS, ZINC PLATED (PR-2 STEEL DRIVE ROD 2' LONG WITH 1/4" ROUND DRIVING TIP NEEDED TO INSTALL ANCHORS. ONE ROD, NOT INCLUDED IN KIT, DRIVES HUNDREDS OF ANCHORS)
- 3, 12" RUBBER TREE COLLARS

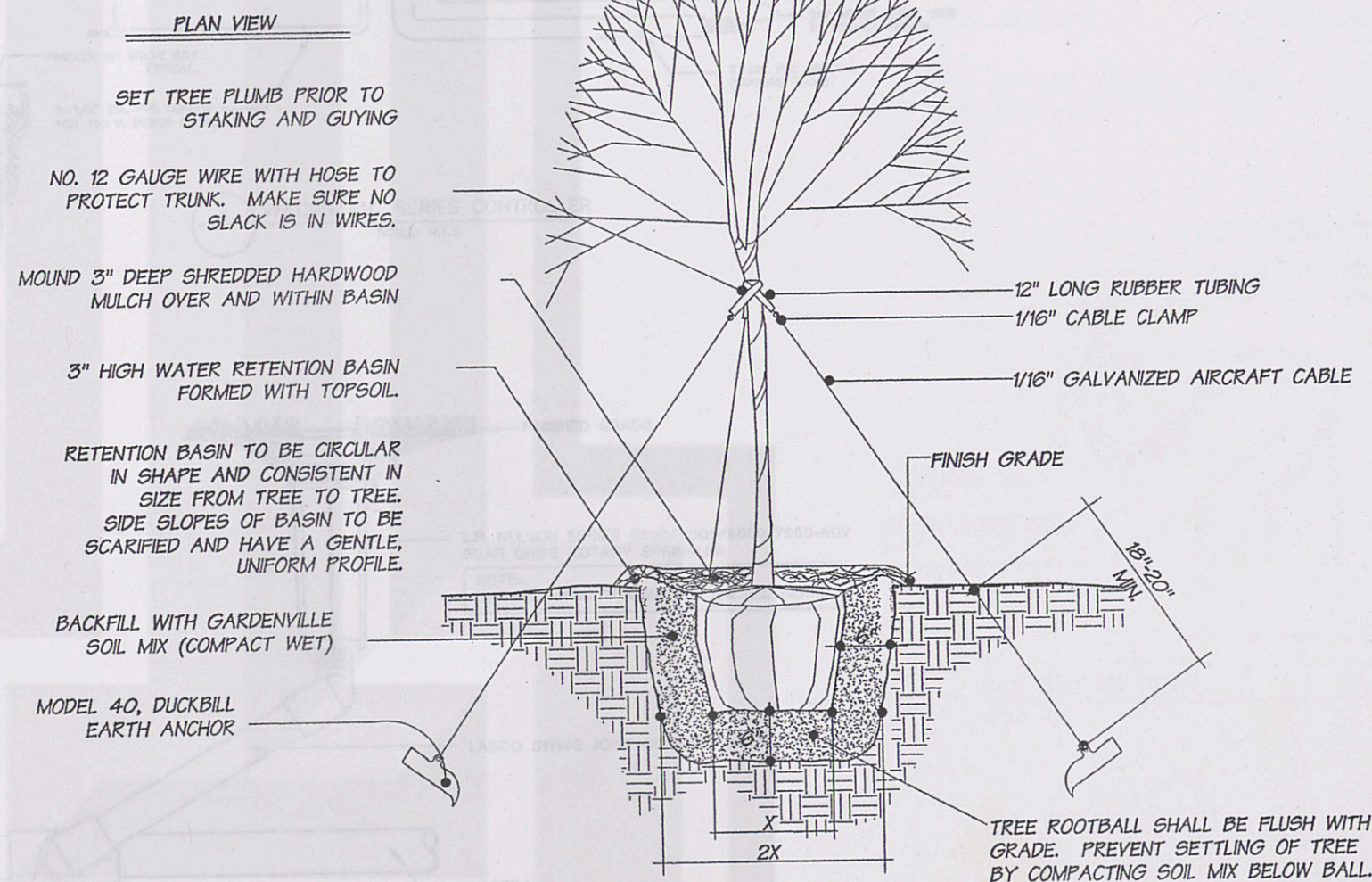

5 TREE PLANTING - GUYING ON LEVEL GROUND
000 NOT TO SCALE

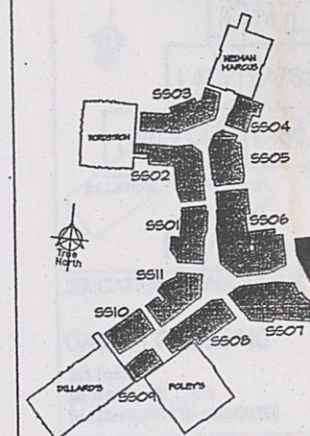

key plan

2 July 17, 2003-100% Design Development

SCALE	As Shown	DATE	07.17.03
-------	----------	------	----------

1 02.03.03 Schematic Design Submittal

No.	Date & Description of Issue
1	1990-1991
2	1992-1993
3	1994-1995
4	1996-1997
5	1998-1999
6	2000-2001
7	2002-2003
8	2004-2005
9	2006-2007
10	2008-2009
11	2010-2011
12	2012-2013
13	2014-2015
14	2016-2017
15	2018-2019
16	2020-2021
17	2022-2023
18	2024-2025
19	2026-2027
20	2028-2029
21	2030-2031
22	2032-2033
23	2034-2035
24	2036-2037
25	2038-2039
26	2040-2041
27	2042-2043
28	2044-2045
29	2046-2047
30	2048-2049
31	2050-2051
32	2052-2053
33	2054-2055
34	2056-2057
35	2058-2059
36	2060-2061
37	2062-2063
38	2064-2065
39	2066-2067
40	2068-2069
41	2070-2071
42	2072-2073
43	2074-2075
44	2076-2077
45	2078-2079
46	2080-2081
47	2082-2083
48	2084-2085
49	2086-2087
50	2088-2089
51	2090-2091
52	2092-2093
53	2094-2095
54	2096-2097
55	2098-2099
56	2100-2101
57	2102-2103
58	2104-2105
59	2106-2107
60	2108-2109
61	2110-2111
62	2112-2113
63	2114-2115
64	2116-2117
65	2118-2119
66	2120-2121
67	2122-2123
68	2124-2125
69	2126-2127
70	2128-2129
71	2130-2131
72	2132-2133
73	2134-2135
74	2136-2137
75	2138-2139
76	2140-2141
77	2142-2143
78	2144-2145
79	2146-2147
80	2148-2149
81	2150-2151
82	2152-2153
83	2154-2155
84	2156-2157
85	2158-2159
86	2160-2161
87	2162-2163
88	2164-2165
89	2166-2167
90	2168-2169
91	2170-2171
92	2172-2173
93	2174-2175
94	2176-2177
95	2178-2179
96	2180-2181
97	2182-2183
98	2184-2185
99	2186-2187
100	2188-2189
101	2190-2191
102	2192-2193
103	2194-2195
104	2196-2197
105	2198-2199
106	2200-2201
107	2202-2203
108	2204-2205
109	2206-2207
110	2208-2209
111	2210-2211
112	2212-2213
113	2214-2215
114	2216-2217
115	2218-2219
116	2220-2221
117	2222-2223
118	2224-2225
119	2226-2227
120	2228-2229
121	2230-2231
122	2232-2233
123	2234-2235
124	2236-2237
125	2238-2239
126	2240-2241
127	2242-2243
128	2244-2245
129	2246-2247
130	2248-2249
131	2250-2251
132	2252-2253
133	2254-2255
134	2256-2257
135</	

The Shops at La Cantera

FM 1604 and LH 10
San Antonio, Texas.

OWNER
LA CANTERA RETAIL
LIMITED PARTNERSHIP
Contact: Gregory Zimmerman
The Rouse Company
Tel: 702.791.4311 / Fax: 702.791.4486

ARCHITECT

ALAMO ARCHITECTS

108 King William
San Antonio, Tx. 78204
Tel: 210.277.2612 / Fax: 210.277.9457

LANDSCAPE ARCHITECT

J. ROBERT ANDERSON FASLA

1715 S. Capital of Texas Highway Suite 105
Austin Tx. 78746
Tel : 512.329.8882 / Fax : 512.329.8883

STRUCTURAL ENGINEER
JASTER - QUINTANILLA
SAN ANTONIO, LLP.

125 West Sunset
San Antonio, Tx. 78209
Tel. • 210 349 9068 / Fax • 210 349 0146

MEP ENGINEER

GOETTING & ASSOCIATES INC.

12042 Blanco Road
San Antonio, Tx. 78216
Tel 210.530.7000 / Fax : 210.377.0256

CIVIL ENGINEER

**PAPE • DAWSON
ENGINEERS INC.**

555 E. Ramsey
San Antonio, Tx. 78216
Tel : 210.375.9000 / Fax : 210.375.9020

PRELIMINARY

NOT FOR REGULATOR
APPROVAL PERMIT, OR
CONSTRUCTION

BOB ANDERSON
TEXAS REG. NO. 754

JOB NO.:	XXXX
----------	------

SHEET TITLE & NO.:

Common Area Planting Details

L520